

ENGINE ZERO 260/92

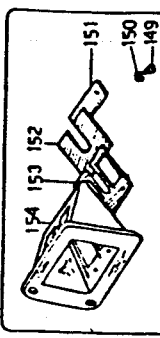
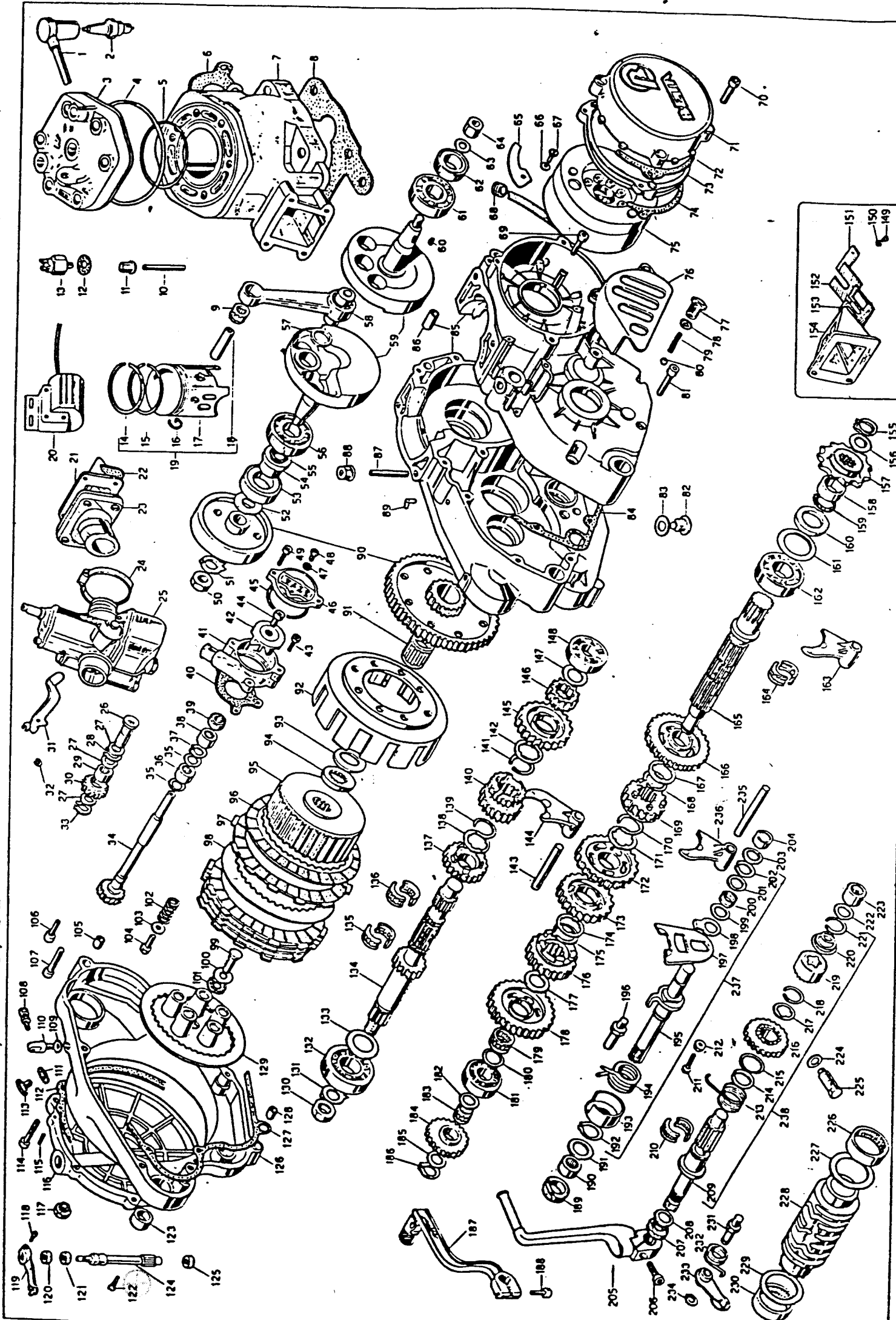

LISTA TAVOLA RICAMBI 37.6603.0.00 ENGINE ZERO-260/92

Riga	Articolo	Descrizione
1	27.1351.0.00	SPARK PLUG PROTECTOR
2	12.2510.0.00	SPARK PLUG CW 9L / N-3
3	19.1218.0.58	CYLINDER HEAD ZERO 260/91
4	10.6789.0.00	OIL SEAL 120.32.125.56.2.42
5	10.6719.0.00	OIL SEAL 88.62.92.18.1.78
6	16.8070.0.00	GASKET ZERO
7	12.5178.0.58	CYLINDER D.74 ZERO
8	16.6171.0.00	CYLINDER CRANKCASE GASKET ZERO
9	18.1675.0.00	NEEDLE BEARING 18.22.25
10	25.9714.0.00	STUD BOLT 8.57
11	13.1711.0.00	NUT M8
12	16.4950.0.00	GASKET 8.20.1.5
13	29.1196.0.00	THERMOSTAT ZERO
14	28.5217.0.00	PISTON RING D.76 ZERO
15	28.5217.0.00	PISTON RING D.76 ZERO
16	10.4260.0.00	CIRCLIP 18
17	25.6457.0.00	PISTON 76 ZERO
18	28.9410.0.00	PISTON PIN 18.60
19	25.8667.8.00	COMP.PISTON D.76 ZERO
20	11.2056.0.00	ELECTRONIC H.T. COIL
21	31.0509.8.00	REED VALVE TR-32
22	16.9253.0.00	VALVE GASKET 200-TR/RV
23	27.2337.0.00	INLET MANIFOLD TR-34
24	15.1538.0.00	CLAMP 25/45
25	12.0487.0.00	CARBURETOR PHB 26 ZERO
26	25.5714.0.00	FUEL MIXER DRIVING PIN RX/85
27	27.5850.0.00	WASHER 10.17
28	22.2710.0.00	SEEGER 10E
29	11.2210.0.00	NEEDLE BEARING 10.14.10
30	18.8260.0.00	GEAR
31	21.2750.0.00	LEVER ZERO
32	28.2257.0.00	SEEGER D.5 ZERO
33	28.2270.0.00	SEEGER 10E
34	10.2770.0.00	COUNTER SHAFT ZERO
35	10.2771.0.00	COUNTER SHAFT ZERO-92
36	27.5850.0.00	WASHER 10.17
37	11.2210.0.00	NEEDLE BEARING 10.14.10
38	11.2210.0.00	NEEDLE BEARING 10.14.10
39	10.4452.0.00	OIL SEAL 10.18.5/8
40	18.7586.0.00	PUMP GASKET ZERO
41	31.2176.0.58	PUMP BODY ZERO
42	31.2182.0.00	PUMP FAN 4M/PH
43	31.3001.0.00	PUMP FAN ZERO-92
44	31.2991.0.00	SCREW 5.12
45	28.2266.0.00	SEEGER 9E
46	10.6487.0.00	OIL SEAL 34.65.38.61.1.78
47	12.6778.0.58	PUMP COVER ZERO
48	16.4750.0.00	GASKET 6.12.1.5
49	31.8000.0.00	SCREW 6.7
50	31.2900.0.00	SCREW 5.12
51	27.7476.0.00	WASHER 14
52	22.3197.0.00	SPRING ZERO
53	10.6500.0.00	OIL SEAL 30.52.10
54	13.5514.0.00	SPACER ZERO
55	10.6483.0.00	OIL SEAL 20.24.25.48.2.62
56	12.9946.0.00	BALL BEARING 25.62.17 NYLON
57	27.7367.8.00	CONNECTING ROD ASSY. TR-32
58	11.0369.8.00	CONNECTING ROD ASSY. TR-32
59	10.0041.0.00	CRANKSHAFT TR-34/CAMP.
60	12.4600.0.00	WOODRUFF KEY 3.3.7.9.7
61	12.9946.0.00	BALL BEARING 25.62.17 NYLON
62	10.6486.0.00	OIL SEAL 25.40.7
63	27.5775.0.00	SPECIAL WASHER
64	13.2710.0.00	SPECIAL NUT 12.1.25.17
65	25.5805.0.00	PLATE
66	27.3480.0.00	WASHER 4.14
67	31.2480.0.00	SCREW 4.14
68	28.9150.0.00	SILENT BLOCK
69	31.2480.0.00	SCREW 4.14
70	31.3105.0.00	SCREW 4.14
71	12.6767.0.58	MAGNETO COVER ZERO-91
72	16.7511.0.00	MAGNETO COVER GASKET
73	12.6767.0.60	INTERNAL MAGNETO COVER ZERO
74	16.7509.0.00	MAGNETO COVER GASKET TR-125

LISTA TAVOLA RICAMBI 37.6603.0.00 ENGINE ZERO-260/92

Riga	Articolo	Descrizione
75	31.0328.0.00	ELECTRIC FLYWHEEL ZERO
76	12.7308.0.58	PINION COVER ZERO-91
77	11.7300.0.00	HOLLOW BOLT
78	16.5600.0.00	GASKET 12.16.1.5
79	22.4200.0.00	HOLLOW BOLT SPRING
80	28.8935.0.00	BALL 5/16
81	31.6951.0.00	MAGNETIC PLUG
82	29.0045.0.00	GASKET 16.22.5.1
83	16.5360.0.00	CRANKCASE GASKET 250-RX/85
84	12.0617.0.60	CRANKCASE ZERO M8
85	16.4001.0.00	DOWEL 10.30
86	25.9807.0.00	STUD BOLT 8.50
87	13.1712.0.00	NUT M8
88	27.8338.0.00	BREATHING PIPE HOSE TR-32
89	29.0725.0.00	PRIMARY DRIVE TR/92
90	16.1718.0.00	NEEDLE BEARING 20.26.20
91	12.2075.0.00	CLUTCH HOUSING TR-34/CAMP.
92	27.7363.0.00	WASHER 20.30.0.5
93	27.4587.0.00	WASHER TR-89
94	29.1019.0.00	CLUTCH CENTER TR-89
95	13.4355.0.00	CLUTCH PLATE TR-92
96	13.4330.0.00	CLUTCH PLATE TR-92
97	13.3835.0.00	STEEL PLATE TR-92
98	25.4510.0.00	TOOTHED CLUTCH PIN TR-34/CAMP.
99	27.7405.0.00	WASHER
100	16.1134.0.00	NEEDLE BEARING 10.22.2.8
101	28.4544.0.00	CLUTCH SPRING TR-34/R
102	27.9750.0.00	WASHER 6.16.1
103	11.4901.0.00	BOLT 6.20
104	16.3701.0.00	DOWEL 9.15
105	31.4500.0.00	SCREW 4.30
106	31.4851.0.00	SCREW 4.35
107	27.2701.0.00	CLUTCH ADJUSTER WITH NUT
108	16.4900.0.00	GASKET 8.14.1.5
109	23.1301.0.00	RATCHET
110	16.5360.0.00	GASKET 16.22.5.1
111	29.1059.0.00	EXT.CLUTCH COVER GASKET TR/89
112	16.7135.0.00	OIL PLUG
113	31.3105.0.00	SCREW 4.15
114	16.3570.0.00	DOWEL TR/89
115	12.6310.0.58	EXT.CLUTCH COVER ZERO-92
116	29.1003.0.00	OIL PLUG ZERO-91
117	31.2680.0.00	SCREW 4.14
118	10.4370.0.00	CLUTCH PIN LEVER
119	11.2230.0.00	NEEDLE BEARING 14.20.12
120	31.8800.0.00	SPECIAL SCREW
121	11.3105.0.00	SINTERED BUSH 125-81
122	25.4399.0.00	CLUTCH PIN TR-240
123	11.2207.0.00	NEEDLE BEARING 9.13.10
124	12.6244.0.58	CLUTCH COVER ZERO-91
125	16.7157.0.00	CLUTCH COVER GASKET 125-81
126	18.3701.0.00	DOWEL 9.15
127	12.2957.0.00	PRESSURE PLATE TR-34/CAMP.
128	19.2895.0.00	S/ARM SPECIAL NUT 14.1.25.7
129	27.7476.0.00	WASHER 14
130	12.9900.0.00	BALL BEARING 20.52.15
131	27.7363.0.00	WASHER 20.30.0.5
132	10.2333.8.00	MAIN SHAFT TR-34/CAMP.
133	16.1487.0.00	NEEDLE BEARING 16.21.10 -2 PCS
134	16.1487.0.00	NEEDLE BEARING 16.21.10 -2 PCS
135	18.3849.8.00	5TH GEAR - MAINSHAFT
136	28.2545.0.00	SEEGER 19 SW
137	28.2545.0.00	SEEGER 19 SW
138	28.2545.0.00	SEEGER 19 SW
139	28.2545.0.00	SEEGER 19 SW
140	28.2545.0.00	SEEGER 19 SW
141	28.2545.0.00	SEEGER 19 SW
142	28.2545.0.00	SEEGER 19 SW
143	25.5106.0.00	SELECTOR PIN 10.87 125/76
144	13.4456.0.00	SELECTOR FORK 28.15 125-76
145	18.3877.8.00	6TH GEAR - MAINSHAFT
146	18.3221.8.00	2ND GEAR - MAINSHAFT
147	27.4450.0.00	WASHER 15.25
148	12.9400.0.00	BALL BEARING 15.35.11
149	31.2302.0.00	SCREW 3.8
150	27.3401.0.00	WASHER 3
151	25.5768.0.00	PETAL FIXING PLATE 4M/PH

LISTA TAVOLA RICAMBI 37.6603.0.00 ENGINE ZERO-260/92

Riga	Articolo	Descrizione
152	21.1545.0.00	OUTER PETAL
153	21.1540.0.00	INNER PETAL
154	31.1354.0.00	REED VALVE TR-32/FD
155	28.2540.0.00	SEEGER 20 E
156	27.7384.0.00	SPECIAL WASHER
157	25.6081.0.00	SPROCKET Z.10
158	13.5521.0.00	SPROCKET SPACER
159	10.6644.0.00	OIL SEAL 20.35.23.91.1.78
160	10.6456.0.00	OIL SEAL 25.37.5
161	27.7415.0.00	WASHER 27.45.0.5
162	12.9900.0.00	BALL BEARING 20.52.15
163	15.6425.0.00	SELECTOR FORK 32.5 TR-200/83
164	16.1657.0.00	NEEDLE BEARING 18.22.10 -2 PCS
165	10.2933.8.00	LAYSHAFT TR-90
166	18.5311.8.00	2ND GEAR - LAYSHAFT TR-34
167	27.7387.0.00	SPECIAL WASHER
168	28.2546.0.00	SEEGER 20 SW
169	18.4711.8.00	4TH GEAR - LAYSHAFT TR-34
170	28.2546.0.00	SEEGER 20 SW
171	27.7387.0.00	SPECIAL WASHER
172	18.5891.8.00	3RD GEAR - LAYSHAFT
173	18.6479.8.00	4TH GEAR - LAYSHAFT
174	27.7387.0.00	SPECIAL WASHER
175	28.2546.0.00	SEEGER 20 SW
176	18.6641.8.00	5TH GEAR - LAYSHAFT
177	27.7256.0.00	WASHER 18.27.0.2
178	18.4307.8.00	1ST GEAR - LAYSHAFT
179	16.1456.0.00	NEEDLE BEARING 18.22.10
180	27.6450.0.00	WASHER 15.25
181	12.9400.0.00	BALL BEARING 15.35.11
182	27.6450.0.00	WASHER 15.25
183	16.1284.0.00	NEEDLE BEARING 15.19.10
184	18.6780.0.00	GEAR
185	27.6450.0.00	WASHER 15.25
186	28.2360.0.00	SEEGER 15E
187	21.2113.0.00	SHIFT LEVER ZERO-91
188	11.4951.0.00	BOLT 6.25
189	10.4800.0.00	OIL SEAL 12.22.5
190	11.2250.0.00	NEEDLE BEARING 12.18.12
191	27.6000.0.00	WASHER 12.22
192	28.2490.0.00	SEEGER 18.1 E
193	28.1595.0.00	SPRING RETAINER
194	22.1700.0.00	SELECTOR SPRING
195	10.1316.0.00	SELECTOR SHAFT 125-76
196	25.4322.0.00	PIN FOR RETURNING SPRING
197	31.2096.0.00	SHIFT CONTROL FORK 125/76
198	27.7855.0.00	WASHER
199	27.6000.0.00	WASHER 12.22
200	22.6800.0.00	SHIFT CONTROL SPRING
201	27.6000.0.00	WASHER 12.22
202	28.12275.0.00	SEEGER 18E
203	27.6000.0.00	WASHER 12.22
204	11.2220.0.00	NEEDLE BEARING 12.18.12
205	21.5511.0.00	KICKSTARTER LEVER ZERO
206	31.4851.0.00	SCREW 6.35
207	10.5800.0.00	OIL SEAL 14.24.5
208	27.6750.0.00	WASHER 16.25
209	10.1510.8.00	STARTER SHAFT 125-CR/81
210	16.1657.0.00	NEEDLE BEARING 18.22.10 -2 PCS
211	31.4500.0.00	SCREW 6.30
212	13.1150.0.00	NUT 6.3.5
213	28.7897.0.00	KICKSTARTER SPRING 125/81
214	28.2545.0.00	SEEGER 19 SW
215	27.7362.0.00	WASHER 20.30.2
216	18.1460.8.00	STARTER GEAR 125-CR/81
217	27.7386.0.00	SPECIAL WASHER
218	28.2545.0.00	SEEGER 19 SW
219	28.1410.8.00	KICKSTARTER SLEEVE 125-CR/81
220	28.3656.0.00	CONICAL SPRING
221	28.2544.0.00	SEEGER 20 SW
222	27.4450.0.00	WASHER 15.25
223	11.2240.0.00	NEEDLE BEARING 15.21.12
224	16.3200.0.00	GASKET 12.16.1.5
225	11.6550.0.00	SPECIAL BOLT
226	11.2340.0.00	NEEDLE BEARING 30.37.12
227	27.7425.0.00	WASHER 30.38
228	12.1957.0.00	CAM ZERO-91

P.T.O

PTO

ISTA TAVOLA RICAMBI 37.6603.0.00 ENGINE ZERO-260/92

q.ta	Articolo	Descrizione
229	27.7425	0.00 WASHER 30.38
230	11.2340	0.00 NEEDLE BEARING 30.37.12
231	25.5500	0.00 PIN
232	22.3926	0.00 LOCATING SPRING 125-76
233	21.0901	0.00 LOCATING LEVER 250-6V
234	28.2265	0.00 SEEGER BE
235	25.5107	0.00 SELECTOR PIN 10.103.5
236	15.6437	0.00 SELECTOR FORK 34,5 125-76
237	10.1316	0.00 SELECTOR SHAFT 125-76
238	22.0500	0.00 COMPLETE KICKSTARTER 125-81

RICAMBI NON FIGURANTI

- 12.0049.0.00 GEARBOX TR-90
- 29.0725.0.00 PRIMARY DRIVE TR-92
- 28.0691.8.00 KIT OIL SEAL ZERO-92
- 28.0800.8.00 GASKET SET ZERO-92

PARTS FOR ENGINE 240 CC

- 12.5179.0.58 CYLINDER D.72,8 ZERO
- 25.8668.0.00 PISTON 72,8 ZERO
- 28.5218.0.00 PISTON RING D.72,8 ZERO
- 29.1219.0.58 CYLINDER HEAD ZERO 240/91

PARTS FOR ENGINE 125 CC

- 10.0059.0.00 CRANKSHAFT 125-CR/82
- 10.4257.0.00 CIRCLIP 16.1,2
- 10.4380.0.00 OIL SEAL 8.16.7
- 10.6617.0.00 OIL SEAL 13.19.3
- 10.6618.0.00 OIL SEAL 7.66.11,22.1,78
- 10.6630.0.00 OIL SEAL 17.86.23.10.2.62
- 10.6697.0.00 OIL SEAL 60.05.63.61.1.78
- 10.6698.0.00 OIL SEAL 107.67.111.23.1.78
- 11.0366.8.00 CONNECTING ROD ASSEMBLY 125-76
- 12.0492.0.00 CARBURETOR PHBM 26 TD ZERO 125
- 12.0418.0.00 CRANKCASE ZERO 125
- 12.2513.0.00 SPARK PLUG REC
- 12.5183.0.58 CYLINDER D.54 ZERO 125
- 12.6262.0.58 EXT. CLUTCH COVER TR-89
- 12.6959.0.58 MAGNETO COVER TR-125
- 13.3819.0.00 STEEL PLATE TR-34/CAMP.
- 13.4319.0.00 CLUTCH PLATE TR-34/CAMP.
- 13.4351.0.00 CLUTCH PLATE TR-34/CAMP.
- 13.5517.0.00 SPACER
- 14.1436.0.00 NEEDLE BEARING
- 16.5050.0.00 GASKET 10.15.1
- 16.5571.0.00 CRANKCASE GASKET 125-RX/85
- 16.6167.0.00 CYLINDER-CRANKCASE GASKET
- 16.8066.0.00 GASKET 125-76
- 22.6503.0.00 CLUTCH SPRING TR-34/CAMP.
- 25.6105.0.00 SPROCKET 11 TEETH TR-125
- 25.8612.0.00 PISTON D.54 ZERO-125
- 25.9812.0.00 STUD BOLT 8.60
- 27.6751.0.00 WASHER 16.26.1
- 28.0694.8.00 KIT OIL SEAL ZERO-125
- 28.0799.8.00 GASKET SET ZERO-125
- 28.5569.0.00 PISTON RING D.54 ZERO-125
- 28.9100.0.00 BREATHER PIPE
- 28.9386.0.00 PISTON PIN 16 125/76
- 29.0723.0.00 PRIMARY DRIVE TR-34/125 CAMP.
- 29.1213.0.58 CYLINDER HEAD ZERO 125
- 31.0329.0.00 FLYWHEEL TR-125 12V

